

IMPORTANT EXHAUST EMISSIONS INFORMATION

GROUP E

THIS UNIT IS EQUIPPED WITH AN ACTIVE EXHAUST EMISSIONS CONTROL SYSTEM TO COMPLY WITH CERTAIN CALIFORNIA AIR DISTRICT REGULATIONS FOR GASEOUS (SPARK-IGNITED) EMERGENCY GENERATING SETS, INCLUDING THE SOUTH COAST AIR QUALITY MANAGEMENT DISTRICT. DO NOT TAMPER WITH OR DISABLE ANY PART OF THIS SYSTEM INCLUDING THE EXHAUST CATALYST, CARBURETOR, OXYGEN SENSOR, AIR-FUEL RATIO CONTROLLER, SOLENOID VALVE AND GAS REGULATOR. THESE ITEMS ARE NOT SUBJECT TO PERIODIC MAINTENANCE OR ADJUSTMENT.

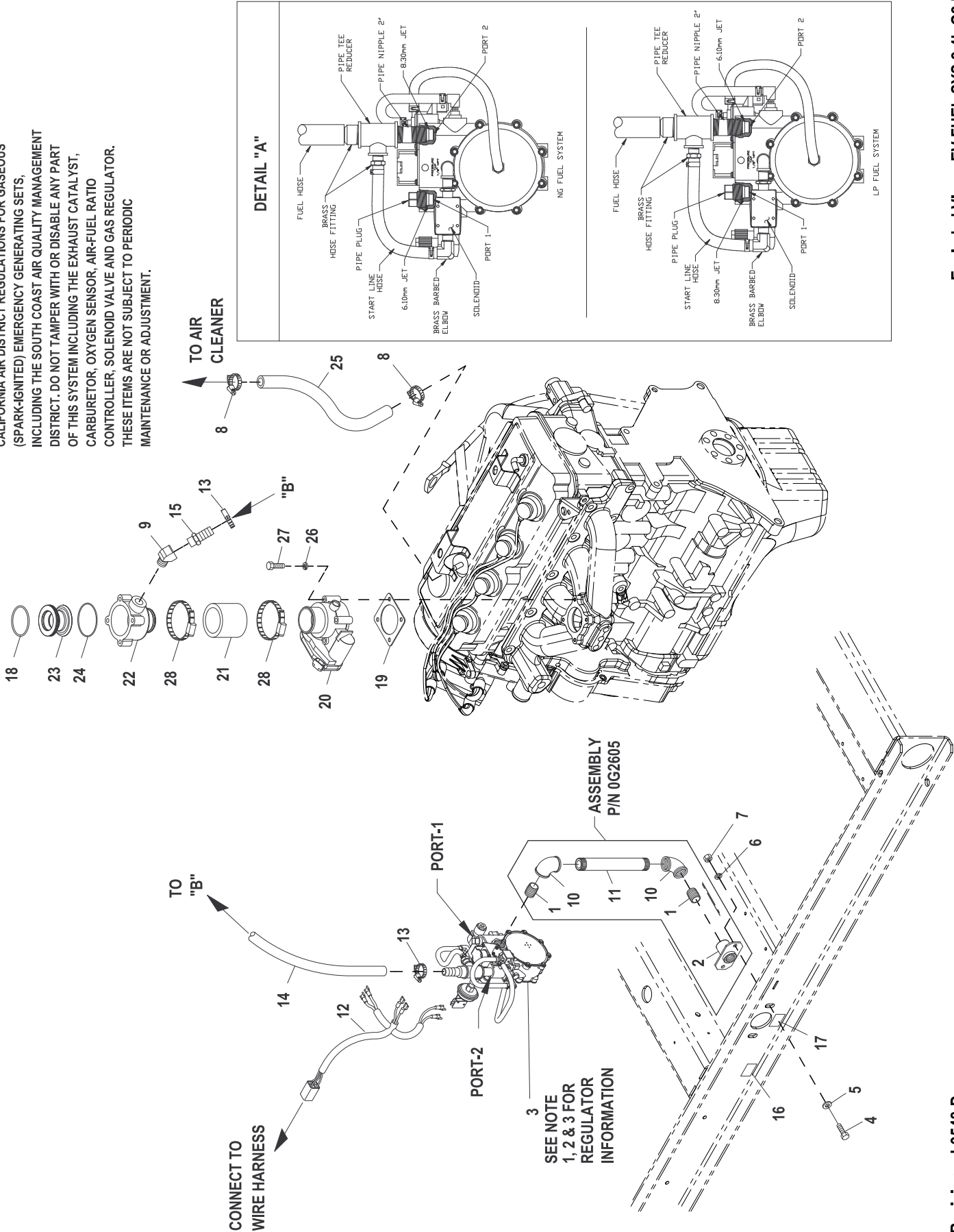

EXPLODED VIEW: EV FUEL SYS 2.4L G2 EMISSIONS**DRAWING #: 0G2547****GROUP E**

ITEM	PART#	QTY.	DESCRIPTION
1	026490	2	NIPPLE PIPE 3/4 NPT X 2
2	075580	1	FLANGE FUEL INLET
3	0F6390D	1	REGULATOR ASSY 2.4L EMISSIONS
4	039253	2	SCREW HHC M8-1.25 X 20 G8.8
5	022145	2	WASHER FLAT 5/16-M8 ZINC
6	022129	2	WASHER LOCK M8-5/16
7	045771	2	NUT HEX M8-1.25 G8 CLEAR ZINC
8	040173	2	CLAMP HOSE #5.5 .62-.62
9	0E8286	1	STREET EL 45D 1/2 NPT BRASS
10	026812	2	ELBOW 90D 3/4 NPT
11	0F8379	1	NIPPLE PIPE 3/4 NPT X 7
12	0F6155	1	HARNESS CPL FUEL JUMPER
13	057823	2	CLAMP HOSE #10 .56 - 1.06
14	059057	1	HOSE 3/4 ID SAE-30R2 (16" LG)
15	047527	1	BARBED STR 1/2 NPT X 3/4
16	0D1509	1	DECAL INLET PRESSURE
17	050279	1	DECAL FUEL INLET NG (NATURAL GAS APPLICATION)
	050280	1	DECAL FUEL INLET LPG (LP VAPOR APPLICATION)
18	0F2119	1	O-RING 45.63 ID X 2.62 WIDTH
19	0E6586	1	GASKET BOSCH 32
20	0E4395	1	ACTUATOR BOSCH 32, GOVERNOR (35KW ONLY)
	0E4394	1	ACTUATOR BOSCH 40 GOVERNOR (45KW ONLY)
21	057753B	1	HOSE 1.5 ID X 2 LG 20R4 (35KW ONLY)
	0K9704	1	HOSE COOLING 2IN ID 20R4 (2IN) (45KW ONLY)
22	0G4537C	1	MIXER ACTUATOR 32MM MACHINED (35KW ONLY)
	0G4537B	1	MIXER ACTUATOR 40MM MACHINED (45KW ONLY)
23	0F7790H	1	VENTURI THROTTLE 19MM (35KW ONLY)
	0F7790E	1	VENTURI THROTTLE 26MM (45KW ONLY)
24	0E7121	1	O-RING 47.625 ID X 2.38 WIDTH
25	047290	1	HOSE 3/8 ID SINGLE BRAID (18" LG)
26	022097	4	WASHER LOCK M6-1/4
27	046580	4	SCREW SHC M6-1.0 X 45 G12.9
28	035685	2	CLAMP HOSE #28 1.32-2.25

RECONFIGURING THE FUEL SYSTEM

Note: All models are configured to run on natural gas from the factory.

To reconfigure the fuel system from NG to LP, follow these steps:

1. Turn the main gas supply off.
2. Remove the carburetor fuel hose from the outlet port of the demand regulator (See Detail "A").
3. Disconnect the power wires from the fuel solenoid located on top of the regulator assembly.
4. Loosen the spring clamp on the small fuel enrichment line and remove the hose from the hose barb.
5. Remove the black pipe assembly from the outlet port of the demand regulator.
6. Remove the NG fuel jet (loosen counter clockwise) from the outlet port.
7. Remove the LP fuel jet (loosen counter clockwise) from the jet keeper port on the side of the regulator housing. Install this jet into the outlet port in the regulator casting.

Note: The jet sizes are stamped on the individual jets. The larger jet size is used for running on NG.

8. Install the previously removed NG jet into the jet keeper port on the side of the regulator housing.
9. Install the previously removed black iron pipe onto the outlet port of the demand regulator.
10. Reverse steps 1-4 in this procedure to reactivate the demand regulator.
11. For LP vapor application substitute LPG fuel inlet decal p/n 050280 for NG fuel inlet decal p/n 050279 (Item 17).
12. When switching fuel types, the proper dip switch settings must be made to the control panel. See owners manual, fuel section, for more details.

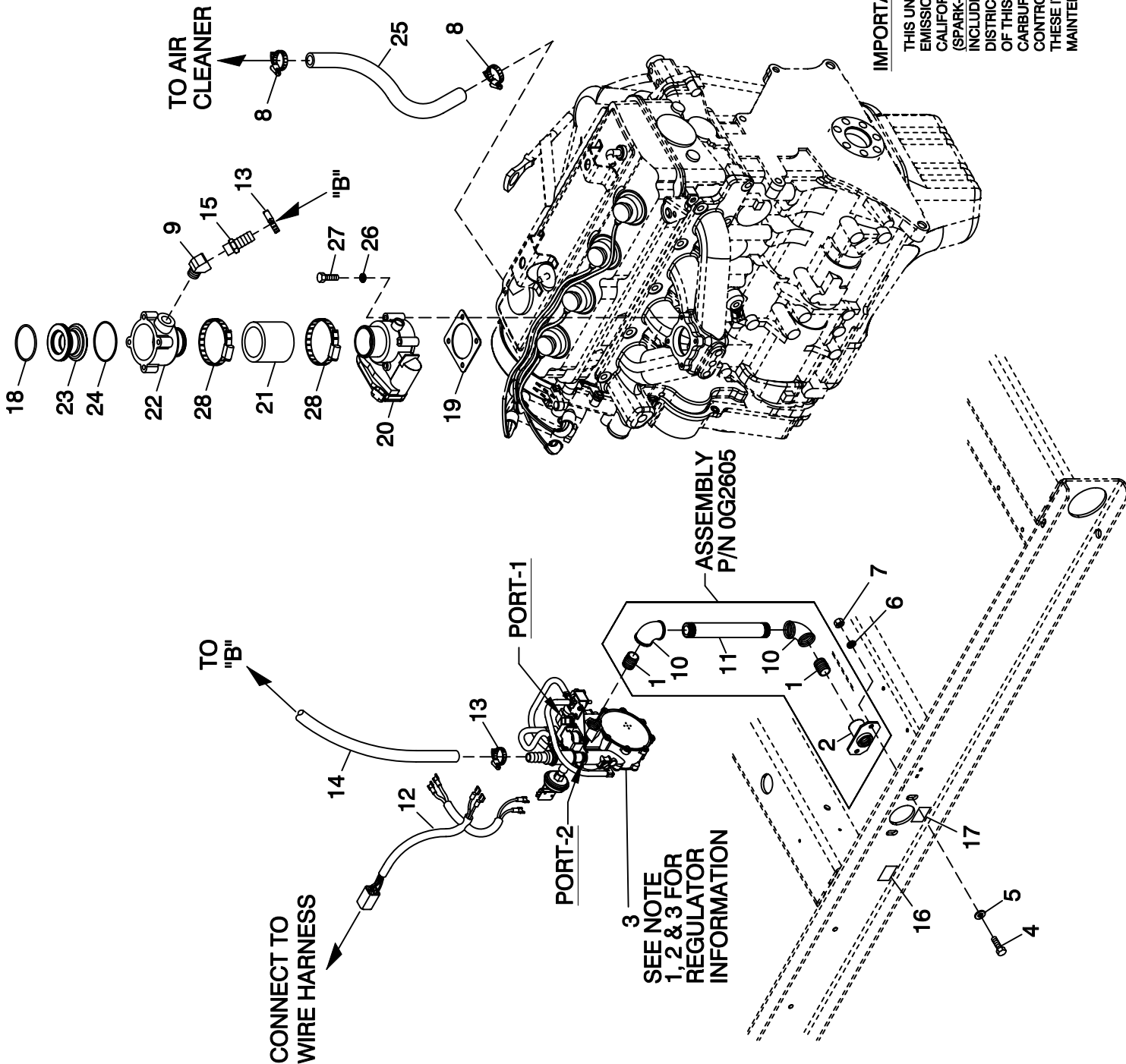

IMPORTANT EXHAUST EMISSIONS INFORMATION

THIS UNIT IS EQUIPPED WITH AN ACTIVE EXHAUST EMISSIONS CONTROL SYSTEM TO COMPLY WITH CERTAIN CALIFORNIA AIR DISTRICT REGULATIONS FOR GASEOUS (SPARK-IGNITED) EMERGENCY GENERATING SETS, INCLUDING THE SOUTH COAST AIR QUALITY MANAGEMENT DISTRICT. DO NOT TAMPER WITH OR DISABLE ANY PART OF THIS SYSTEM INCLUDING THE EXHAUST CATALYST, CARBURATOR, OXYGEN SENSOR, AIR-FUEL RATIO CONTROLLER, SOLENOID VALVE AND GAS REGULATOR. THESE ITEMS ARE NOT SUBJECT TO PERIODIC MAINTENANCE OR ADJUSTMENT.

EXPLODED VIEW:
FUEL SYSTEM EMISSIONS
DRAWING #: 0G2547

EXPLODED VIEW: FUEL SYSTEM EMISSIONS**DRAWING #: 0G2547****GROUP E****APPLICABLE TO:**

ITEM	PART #	QTY.	DESCRIPTION
1	026490	2	NIPPLE PIPE 3/4 NPT X 2
2	075580	1	FLANGE FUEL INLET
3	0F6390D	1	REGULATOR ASSY 2.4L EMISSIONS
4	039253	2	SCREW HHC M8-1.25 X 20 G8.8
5	022145	2	WASHER FLAT 5/16-M8 ZINC
6	022129	2	WASHER LOCK M8-5/16
7	045771	2	NUT HEX M8-1.25 G8 CLEAR ZINC
8	040173	2	CLAMP HOSE #5.5 .62-.62
9	0E8286	1	STREET EL 45D 1/2 NPT BRASS
10	026812	2	ELBOW 90D 3/4 NPT
11	0F8379	1	NIPPLE PIPE 3/4 NPT X 7
12	0F6155	1	HARNESS CPL FUEL JUMPER
13	057823	2	CLAMP HOSE #10 .56 - 1.06
14	059057	1	HOSE 3/4 ID SAE-30R2 (16" LG)
15	047527	1	BARBED STR 1/2 NPT X 3/4
16	0D1509	1	DECAL INLET PRESSURE
17 *	050279	1	DECAL FUEL INLET NG (NATURAL GAS APPLICATION)
	050280	1	DECAL FUEL INLET LPG (LP VAPOR APPLICATION)
18	0F2119	1	O-RING 45.63 ID X 2.62 WIDTH
19	0E6586	1	GASKET BOSCH 32
20	0E4395	1	ACTUATOR BOSCH 32, GOVERNOR (35KW ONLY)
	0E4394	1	ACTUATOR BOSCH 40 GOVERNOR (45KW ONLY)
21	057753B	1	HOSE 1.5 ID X 2 LG 20R4 (35KW ONLY)
	040105	1	HOSE COOL 2 IN ID 20R4 (2" LG) (45KW ONLY)
22	0E6382C	1	VENTURI HOLDER W/32MM ACTUATOR (35KW ONLY)
	0E6382B	1	VENTURI HOLDER W/40MM ACTUATOR (45KW ONLY)
23	0F7790H	1	VENTURI THROTTLE 19MM (35KW ONLY)
	0F7790E	1	VENTURI THROTTLE 26MM (45KW ONLY)
24	0E7121	1	O-RING 47.625 ID X 2.38 WIDTH
25	047290	1	HOSE 3/8 ID SINGLE BRAID (18" LG)
26	022097	4	WASHER LOCK M6-1/4
27	046580	4	SCREW SHC M6-1.0 X 45 G12.9
28	035685	2	CLAMP HOSE #28 1.32-2.25

NOTES (TO CONFIGURE FOR LP VAPOR):

1. REMOVE FUEL HOSE AND START LINE HOSE FROM BRASS HOSE FITTINGS. REMOVE 2" PIPE NIPPLE / ASSEMBLY AND PIPE PLUG FROM DEMAND REGULATOR. MOVE 8.30MM JET FROM PORT 1 TO PORT 2 AND 6.10MM JET FROM PORT 2 TO PORT 1. INSTALL 2" PIPE NIPPLE / ASSEMBLY AND PIPE PLUG WITH PIPE SEALANT COMPOUND. CONNECT FUEL HOSE AND START LINE HOSE TO BRASS HOSE FITTINGS.

NOTES (TO CONFIGURE FOR NATURAL GAS):

2. REMOVE FUEL HOSE AND START LINE HOSE FROM BRASS HOSE FITTINGS. REMOVE 2" PIPE NIPPLE / ASSEMBLY AND PIPE PLUG FROM DEMAND REGULATOR. MOVE 8.30MM JET FROM PORT 2 TO PORT 1 AND 6.10MM JET FROM PORT 1 TO PORT 2. INSTALL 2" PIPE NIPPLE / ASSEMBLY AND PIPE PLUG WITH PIPE SEALANT COMPOUND. CONNECT FUEL HOSE AND START LINE HOSE TO BRASS HOSE FITTINGS.
- 3*. FOR LP VAPOR APPLICATION SUBSTITUTE LPG FUEL INLET DECAL P/N 050280 FOR NG FUEL INLET DECAL P/N 050279 (ITEM17).
4. WHEN SWITCHING FUEL TYPES, THE PROPER DIP SWITCH SETTINGS MUST BE MADE TO THE CONTROL PANEL. SEE OWNERS MANUAL, FUEL SECTION, FOR MORE DETAILS.