

Arrow shown represents direction of exhaust, which flows from inlet end to outlet end of catalyst.

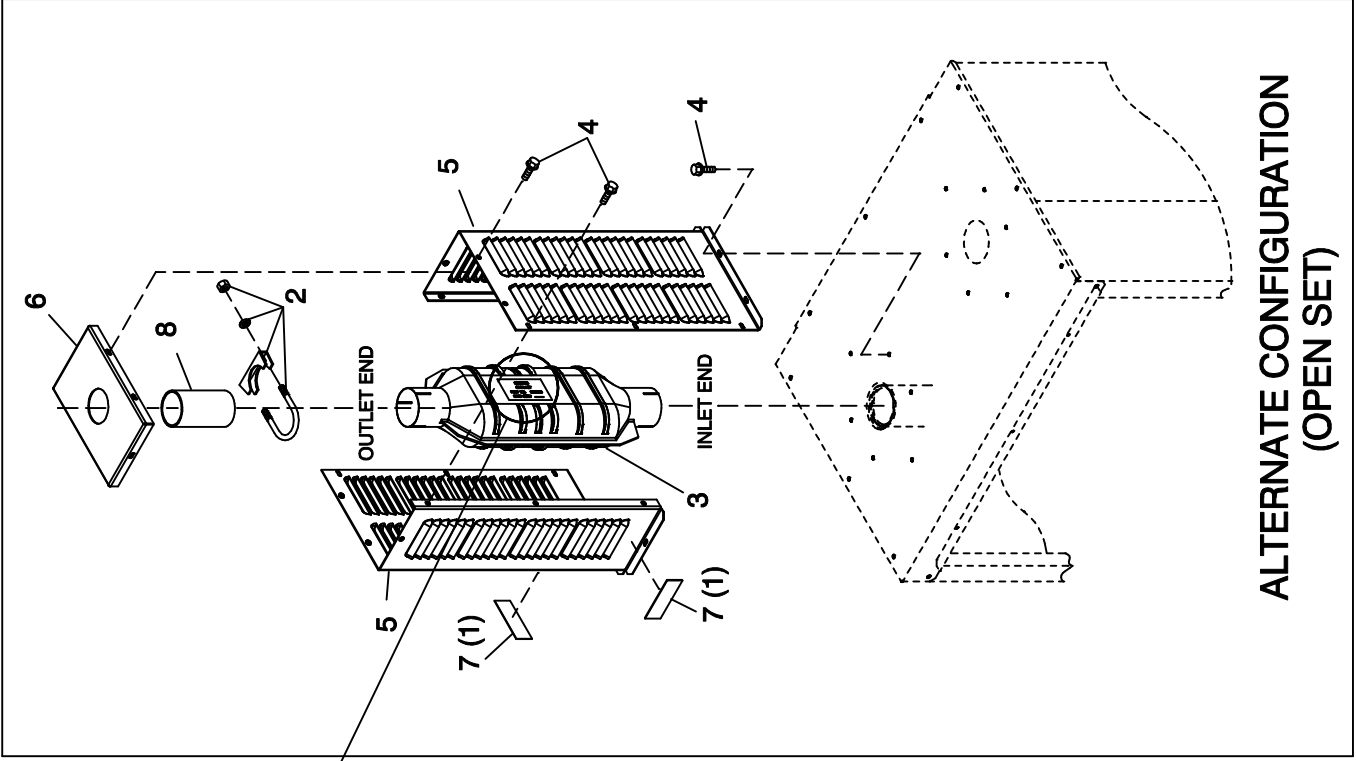

ALTERNATE CONFIGURATION
(OPEN SET)

EXPLODED VIEW:
KIT CATALYST EXHAUST (SHIPPED LOOSE)
DRAWING #: 0G9944A

EXPLODED VIEW: KIT CATALYST EXHAUST (SHIPPED LOOSE)**DRAWING #: 0G9944A****GROUP D****APPLICABLE TO:**

ITEM	PART #	QTY.	DESCRIPTION
1	0F4462	1	RAIN CAP 2-1/2" AL
2	080762	2	BOLT U 3/8-16 X 2.62
3	0H2099	1	CATALYST 3-WAY
4	0C2454	18	SCREW THF M6-1X16 N WA Z/JS
(2) 5	0G97740AL01	2	HEAT SHIELD EXHAUST STACK
(2) 6	0G97750AL01	1	CAP HEAT SHIELD EXHAUST STACK
(1) 7	0G3263	4	DECAL WARNING HOT SURFACES BI
8	0H0260	1	EMISS EXH OUTLET PIPE CPL
(3) 9	077992	18	NUT HEX LOCK M6-1.0 SS NY INS

NOTE:

SOME UNITS MAY REQUIRE (2) KITS.

(1) DECALS APPLIED TO EXHAUST AT THE FACTORY.

(2) PART NUMBER SHOWN IS FOR TAN. SEE GUIDE BELOW FOR AVAILABLE COLOR AND PART NUMBER FORMAT.

0GXXXX0AL08 = GRAY / ALUMINUM 0GXXXXALT13 = BISQUE / ALUMINUM

0GXXXX0AL05 = WHITE / ALUMINUM 0GXXXXALT14 = GRAY / ALUMINUM

0GXXXX0GS0R = GALVANIZED / NO PAINT

(3)) ALUMINUM ENCLOSURE NOTE: ITEM NUMBER 5 TO BE SECURED USING ITEM NUMBERS 4 (THREAD FORMING FASTENER) & 9 (LOCK NUT). THE LOCK NUT IS TO BE INSTALLED AFTER THREAD FORMING FASTENER HAS PENETRATED THROUGH EXTRUSIONS IN ENCLOSURE PANELS.

CATALYST AND HEAT SHIELD ASSEMBLY INSTRUCTIONS:

- 1) Disconnect battery cables to prevent accidental start-up. Disconnect the negative battery cable first from the battery post indicated by (-) or NEG.
- 2) Insert the outlet pipe (0H0260 I/N 8) 2 to 3 inches into the outlet of the catalyst (0H2099, I/N 3). The illustration identifies the catalyst inlet and outlet. Slide one U-bolt (080762, I/N 2) onto the outlet of the catalyst and tighten.
- 3) Slide the remaining U-bolt (080762, I/N 2 (not shown)) and catalyst (0H2099, I/N 3) over the exhaust pipe protruding from the enclosure. The exhaust pipe should be inserted 2 to 3 inches into the inlet of the catalyst (0H2099, I/N 3). The flat side of the catalyst should be aligned with the side of the generator (as shown). Position the U-bolt over the inlet of the catalyst and tighten. This joint must be tight and must not leak.
- 4) Sub-assemble the heat shield panels (0G97740AL01, I/N 5) and the heat shield cap (0G97750AL01, I/N 6) using the screws provided (0C2454, I/N 4). Lock nuts (077992, I/N 9) should be installed after the fastener has penetrated through the extrusions in the heat shield panels. Lock nuts (077992, I/N 9) are not required on open set configurations.
- 5) Slide the heat shield subassembly over the catalyst. The long side of the heat shield assembly should be aligned with the long side of the generator (as shown).
- 6) Fasten the heat shield assembly to the enclosure using the screws provided (0C2454, I/N 4). Lock nuts (077992, I/N 9) should be installed after the fastener has penetrated through the extrusions in the enclosure. An access panel may need to be removed to complete this step. Lock nuts (077992, I/N 9) are not required on open set configurations.
- 7) Install the rain cap over the outlet of the catalyst and tighten (0F4462, I/N 1). Open set configurations do not require a rain cap.

Notes:

- Catalyst must be mounted in described position.
- Failing to follow these instructions when installing a certified engine in a piece of nonroad equipment violates federal law 40 CFR 1068.105 (b), subject to fines or penalties as described in the Clean Air Act.