

- NOTES:
1. MINIMUM RECOMMENDED CONCRETE PAD SIZE: 1092 (43") WIDE X 2355 (93") LONG. REFERENCE INSTALLATION GUIDE SUPPLIED WITH UNIT FOR CONCRETE PAD GUIDELINES.
 2. ALLOW SUFFICIENT ROOM ON ALL SIDES OF THE GENERATOR FOR MAINTENANCE AND SERVICING. THIS UNIT MUST BE INSTALLED IN ACCORDANCE WITH CURRENT APPLICABLE NFPA 37 AND NFPA 70 STANDARDS AS WELL AS ANY OTHER FEDERAL, STATE, AND LOCAL CODES.
 3. CONTROL PANEL / CIRCUIT BREAKER INFORMATION:
 - SEE SPECIFICATION SHEET OR OWNERS MANUAL
 - ACCESSIBLE THROUGH CUSTOMER ACCESS ASSEMBLY DOOR ON REAR OF GENERATOR.
 4. REMOVE THE REAR TANK AND REAR ENCLOSURE COVER PANEL TO ACCESS THE STUB-UP AREAS AS FOLLOWS:
 - HIGH VOLTAGE CONNECTION INCLUDING AC LOAD LEAD CONDUIT CONNECTION NEUTRAL CONNECTION, BATTERY CHARGER 120 VOLT AC (0.5 AMP MAX) CONNECTION.
 - LOW VOLTAGE CONNECTION INCLUDING TRANSFER SWITCH CONTROL WIRES AND ACCESSORY RELAY CONNECTION (QTY 4)
 5. CENTER OF GRAVITY AND WEIGHT MAY CHANGE DUE TO UNIT OPTIONS.
 6. BOTTOM OF GENERATOR SET MUST BE ENCLOSED TO PREVENT PEST INTRUSION AND RECIRCULATION OF DISCHARGE AIR AND/OR IMPROPER COOLING AIR FLOW.
 7. EXHAUST SYSTEM MAXIMUM BACK PRESSURE: 24 INCHES H2O.
 8. REFERENCE OWNERS MANUAL FOR LIFTING WARNINGS.
 9. MOUNTING BOLTS OR STUDS TO MOUNTING SURFACE SHALL BE 5/8-11 GRADE 5 (USE STANDARD SAE TORQUE SPECS)

SERVICE ITEM	2.3L
OIL FILL CAP	RIGHT SIDE
OIL DIP STICK	RIGHT SIDE
OIL FILTER	RIGHT SIDE
OIL DRAIN HOSE	RIGHT SIDE
RADIATOR DRAIN HOSE	LEFT SIDE
AIR CLEANER ELEMENT	EITHER SIDE
MUFFLER	FRONT
FAN BELT	EITHER SIDE
BATTERY	LEFT SIDE

REFERENCE OWNERS MANUAL FOR PERIODIC REPLACEMENT PART LISTINGS.

WEIGHT DATA WITH EMPTY BASETANK (SEE NOTE 5)	
GENERATOR AS SHOWN (STEEL ENCL)	667 [1470]
WITH WODDEN SHIPPING SKID	707 [1555]

WEIGHT: KG [LBS]
DIMENSIONS: MM [INCH]

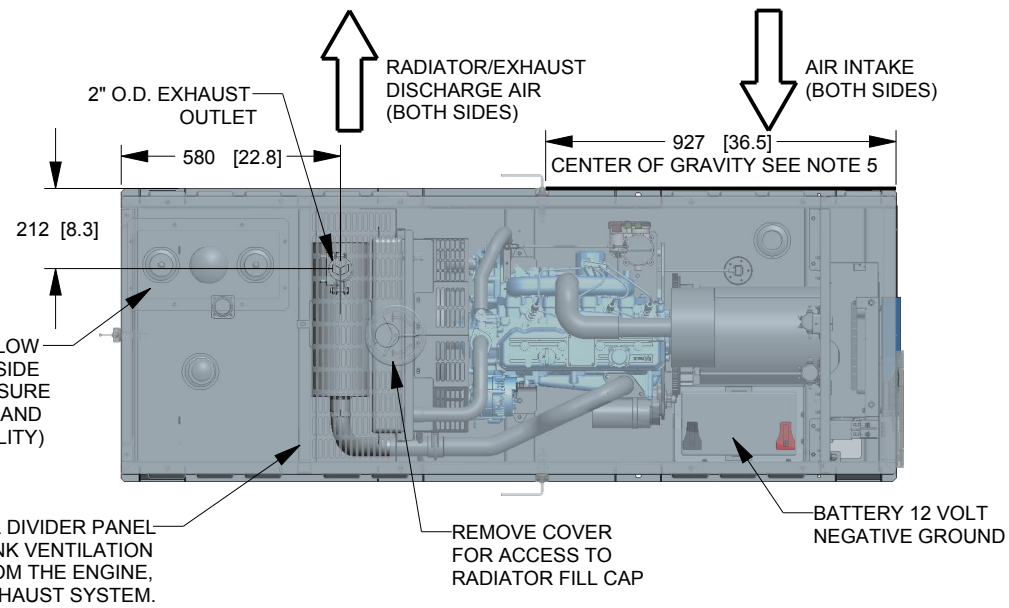

TOP VIEW

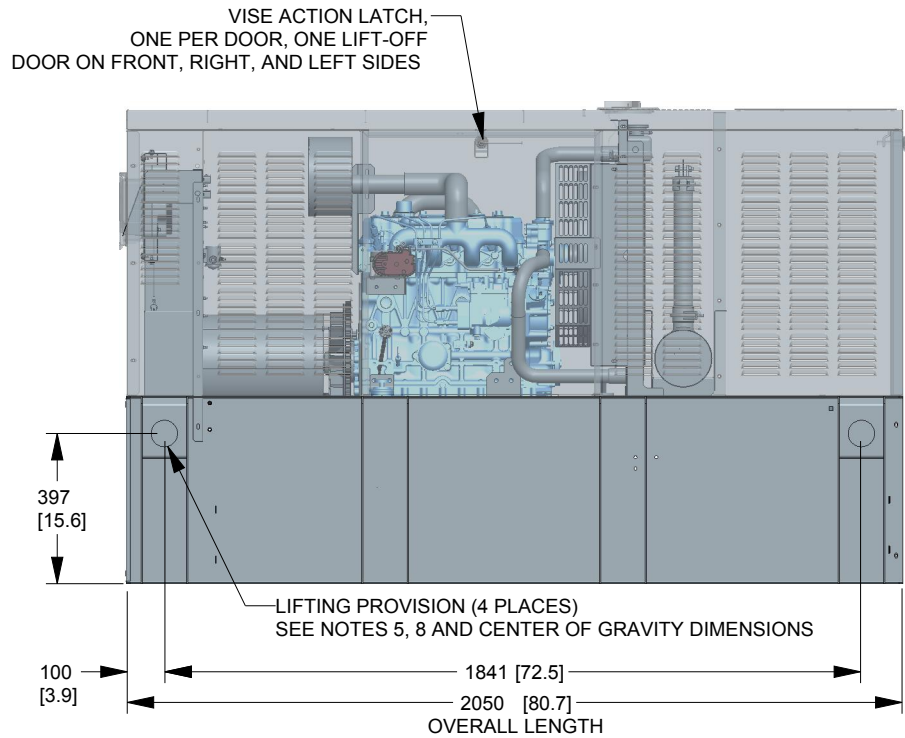

RIGHT SIDE VIEW

LIFT OFF DOOR PROVIDES ACCESS TO:
FUEL FILL, FUEL LEVEL GAUGE,
NORMAL VENT, INNER TANK EMERGENCY VENT,
OUTER TANK EMERGENCY VENT,
OPTIONAL 90% ALARM ASSEMBLY,
OPTIONAL 5 GALLON SPILL BOX

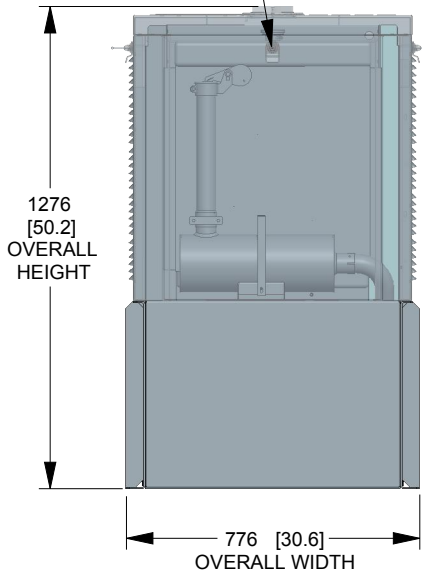

FRONT VIEW

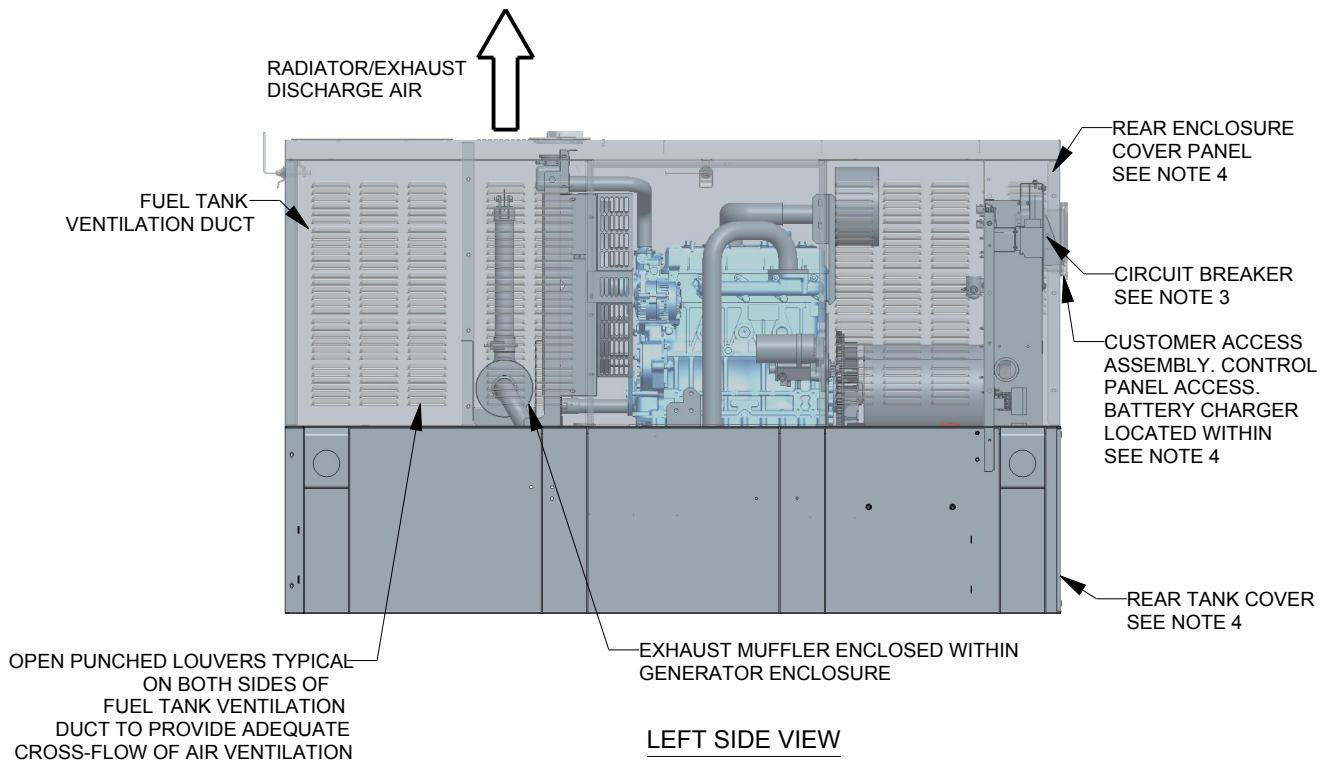

LEFT SIDE VIEW

DRAWING CREATED FROM PRO/ENGINEER 3D FILE. ECO MODIFICATION TO BE APPLIED TO SOLID MODEL ONLY.

INSTALLATION DRAWING

GENERAC POWER SYSTEMS OWNS THE COPYRIGHT OF THIS DRAWING WHICH IS SUPPLIED IN CONFIDENCE AND MUST NOT BE USED FOR ANY PURPOSE OTHER THAN FOR WHICH IT IS SUPPLIED WITHOUT THE EXPRESS WRITTEN CONSENT OF GENERAC POWER SYSTEMS. ©GENERAC POWER SYSTEMS 2013

ELECTRONICALLY APPROVED
INSIDE WINDCHILL



TITLE
INSTALL PROTECTOR D2.3L G16
EXT TANK

ISSUE DATE:		10/2013	
SIZE	CAGE NO	DWG NO	REV
B	N/A	0K4894	A
SCALE	0.050	WT-KG	SHEET 1 of 2

B

B

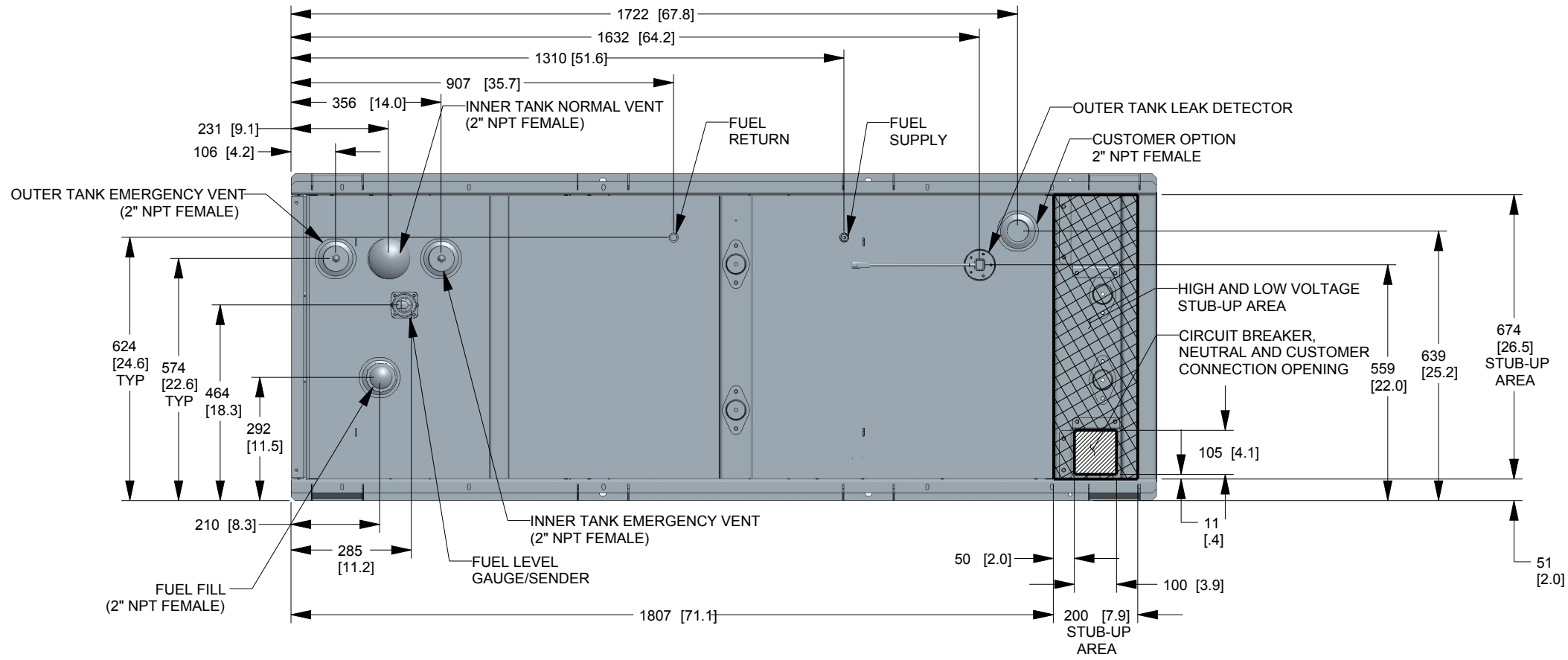

FUEL TANK	
TOTAL CAPACITY	127 [33.5]
USABLE CAPACITY	121 [32]

CAPACITY: LITER [GALLON]
DIMENSIONS: MM [INCH]
TANK IS LISTED TO UL142 AND ULC/ORD-C142.18

A

A

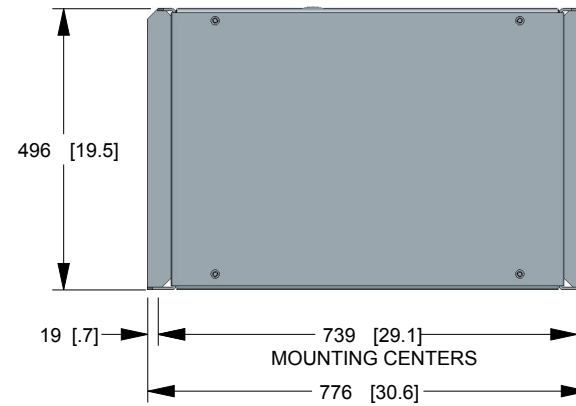
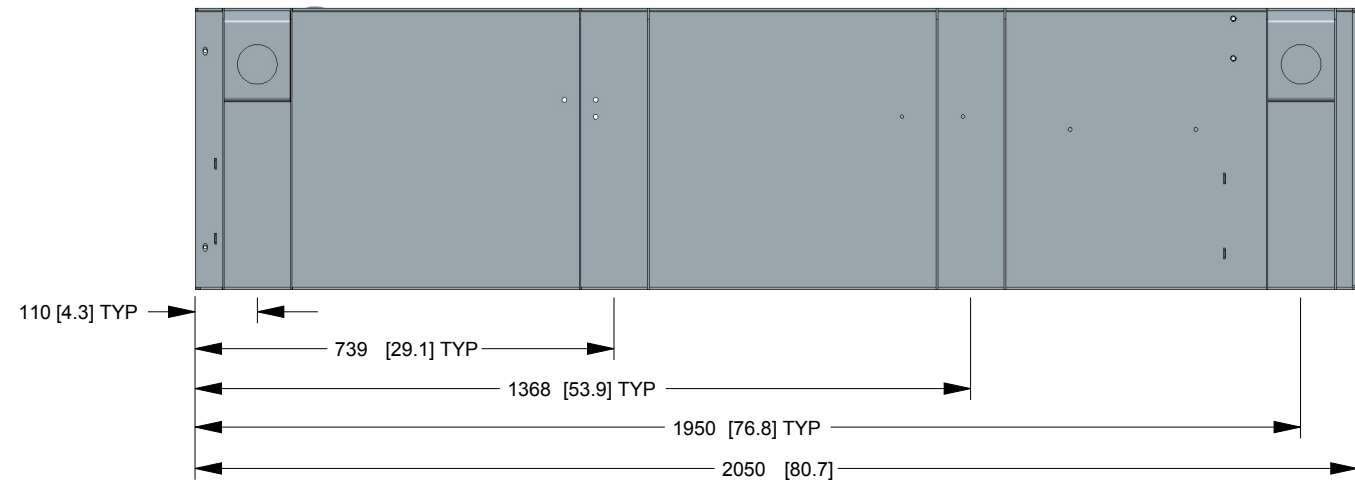

DRAWING CREATED FROM PRO/ENGINEER 3D FILE. ECO MODIFICATION TO BE APPLIED TO SOLID MODEL ONLY.

INSTALLATION DRAWING

GENERAC POWER SYSTEMS OWNS THE COPYRIGHT OF THIS DRAWING WHICH IS SUPPLIED IN CONFIDENCE AND MUST NOT BE USED FOR ANY PURPOSE OTHER THAN FOR WHICH IT IS SUPPLIED WITHOUT THE EXPRESS WRITTEN CONSENT OF GENERAC POWER SYSTEMS. ©GENERAC POWER SYSTEMS 2013

ELECTRONICALLY APPROVED
INSIDE WINDCHILL



TITLE
INSTALL STUB-UP VIEW PROTECTOR D2.3L
EXT TANK

ISSUE DATE:				
SIZE B	CAGE NO	DWG NO 0K4894	REV A	
SCALE	0.075	WT-KG	SHEET	2 of 2