

GROUP E

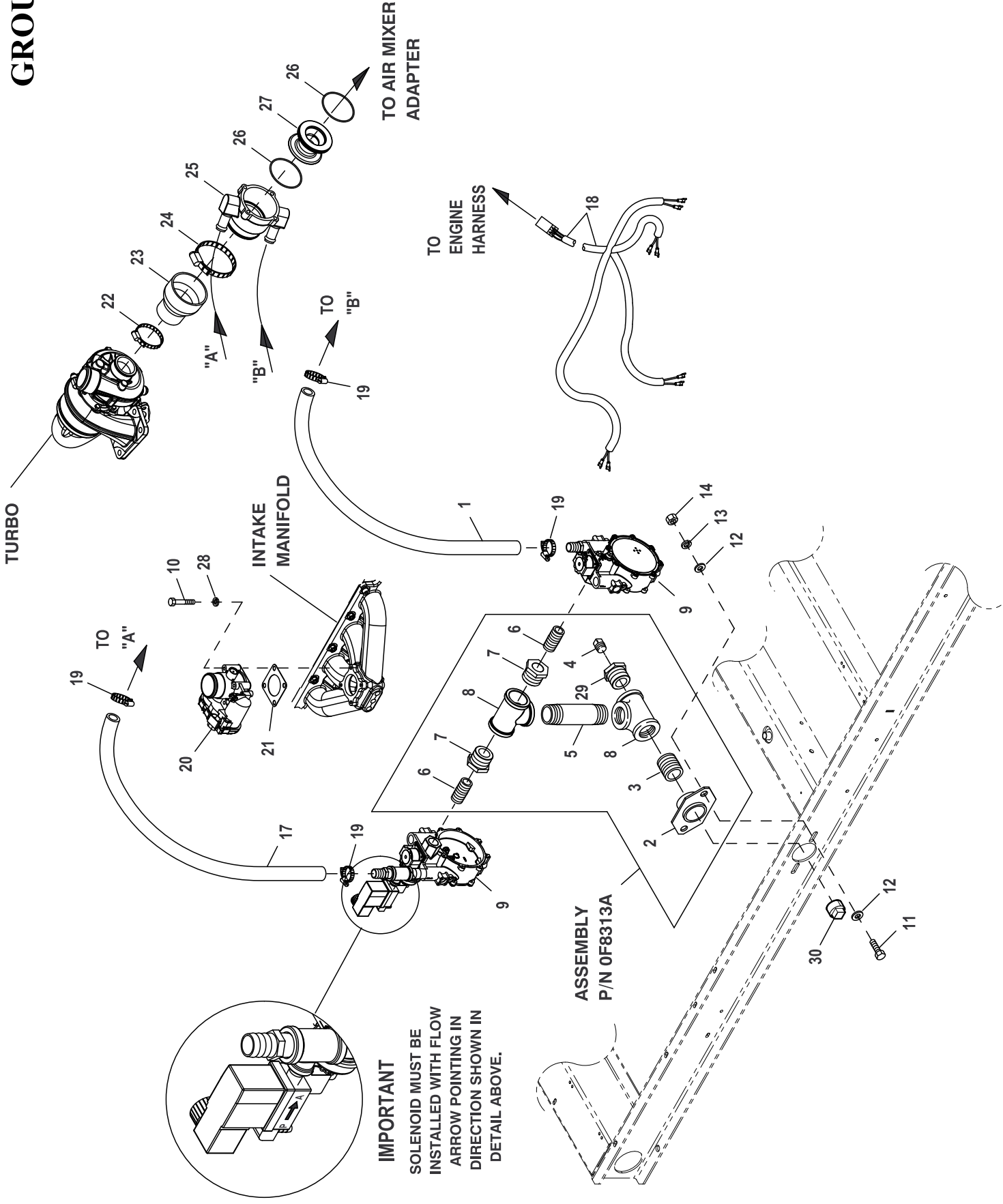

IMPORTANT
SOLENOID MUST BE
INSTALLED WITH FLOW
ARROW POINTING IN
DIRECTION SHOWN IN
DETAIL ABOVE.

EXPLODED VIEW: EV FUEL SYSTEM NG 2.4L 60KW**DRAWING #: 0H7581****GROUP E**

ITEM	PART#	QTY.	DESCRIPTION
1	059057	1	HOSE 3/4 ID SAE-30R2 (43"LG)
2	065908	1	FLANGE FUEL INLET
3	039130	1	NIPPLE CLOSE 1.25 NPT X 1.625
4	026073A	1	PLUG STD PIPE 1/4 STEEL SQ HD
5	088963	1	NIPPLE PIPE 1.25 NPT X 5.5 BL IRN
6	026915	2	NIPPLE CLOSE 3/4 X 1.375
7	0A8064	2	BSHG RDCR HEX 1-1/4-3/4
8	064346	2	PIPE TEE 1-1/4 NPT
9	0G9239C	1	REG ASSY 2.4L 60KW NG CPL
10	046580	4	SCREW SHC M6-1.0 X 45 C12.9
11	052645	2	SCREW HHC M12-1.75 X 30 C8.8
12	022304	4	WASHER FLAT 1/2 ZINC
13	022129	2	WASHER LOCK M8-5/16
14	045771	2	NUT HEX M8-1.25 G8 CLEAR ZINC
17	059057	1	HOSE 3/4 ID SAE-30R2 (43" LG)
18	0H7438	1	HARN FUEL JUMPER DUAL REG
19	057823	4	CLAMP HOSE #10 .56-1.06
20	0E4394	1	ACTUATOR BOSCH 40 GOVERNOR
21	0E6586	1	GASKET BOSCH 32
22	086133C	1	CLAMP HI TORQUE 1.75 - 2.625
23	0F3857	1	REDUCER RUBBER 3.0"-2.00"
24	086133E	1	CLAMP HI TORQUE 2.75 - 3.625
25	0F3885	1	MIXER 40/60MM ACTUATOR ASSY
26	0G3167	2	O-RING 2-3/4 X 3/32 X 2-15/16
27	0F3691	1	VENTURI THROTTLE 32MM
28	022097	4	WASHER LOCK M6-1/4
29	0E7162	1	BSHG RDCR HEX 1-1/4 X 1/4FNPT
30	063831	1	PLUG PIPE 1.25 SQ HD ZINC